

Restrict external access to a Tizen screen

It is possible to control several security parameters on Tizen screens: disabling USB ports, setting a PIN code, disabling the power button, etc...

This guide details each security function on Tizen screens. Some options may not be available depending on the model of your screen, so don't hesitate to let us know if you find something missing.

Please note that if you use a personalised PIN code, you will be the only person able to unlock the screen. If you forget, the only option will be to reset the entire screen.

Lock Activated

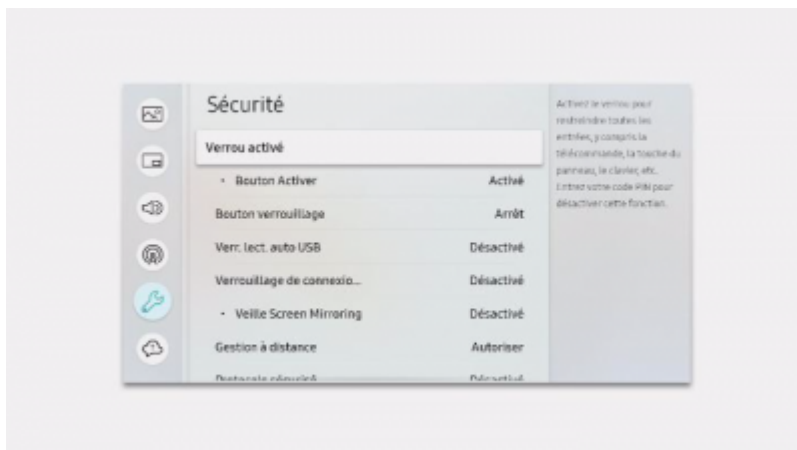

With this option, remote control operations will require confirmation of the PIN code.

Activate button

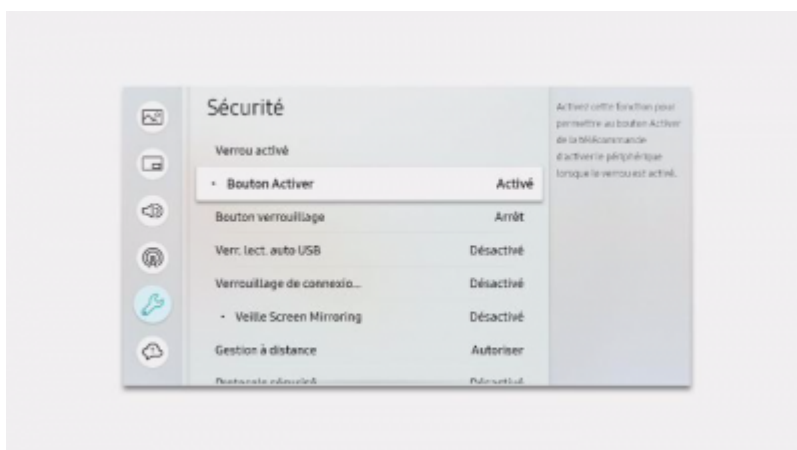

If this function is activated, you will no longer be able to switch on the screen using the remote control if it goes into standby mode.

Lock button



This option enables or disables the physical button on the screen.

USB auto read lock



This option enables or disables automatic playback when a USB stick is connected. (in MagicInfo)

Mobile connection lock

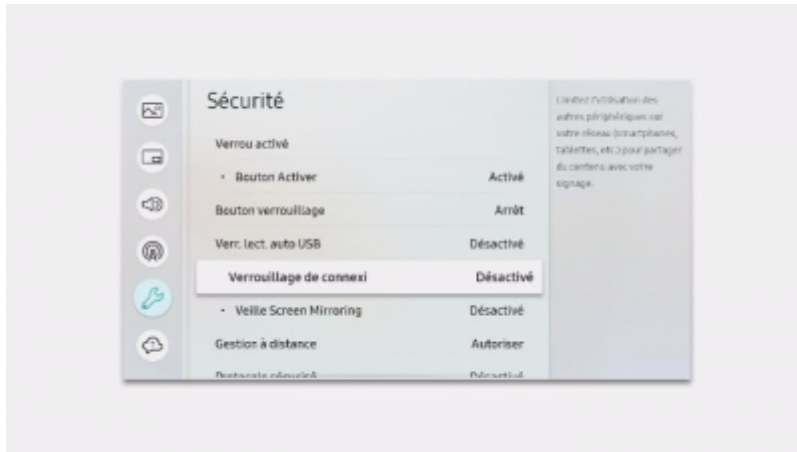

This option allows you to enable or disable Screen Mirroring (smartphone, etc) to control the broadcast.

Touch control lock

This option allows you to deactivate the touch screen if your peripheral is compatible.

Screen Mirroring Standby

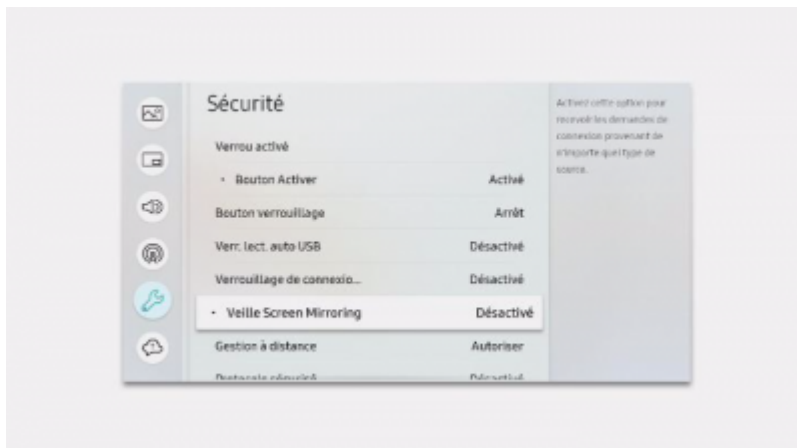

This option allows you to authorise or not the resumption of old functions when the device is controlled by Screen Mirroring (smartphone).

Remote management



This option must be set to “Authorize” for Zebrix to work properly.

Secure protocol

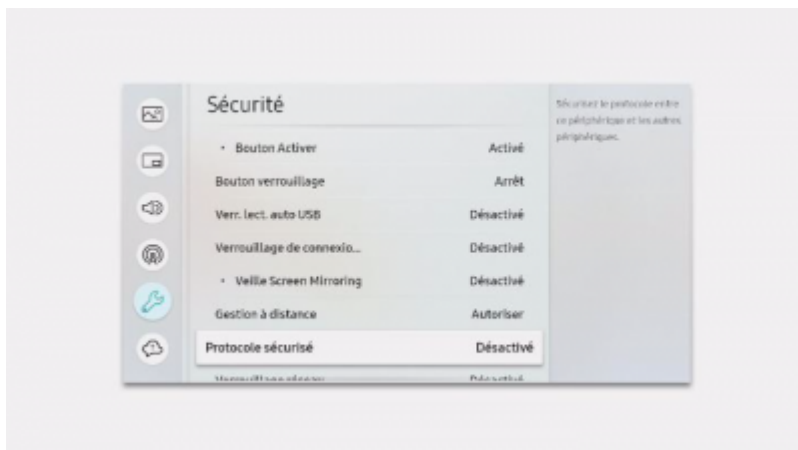

Secures protocols between the screen and other peripherals.

Network lock



This option allows you to authorise or prevent connection to networks other than the one currently active.

USB lock

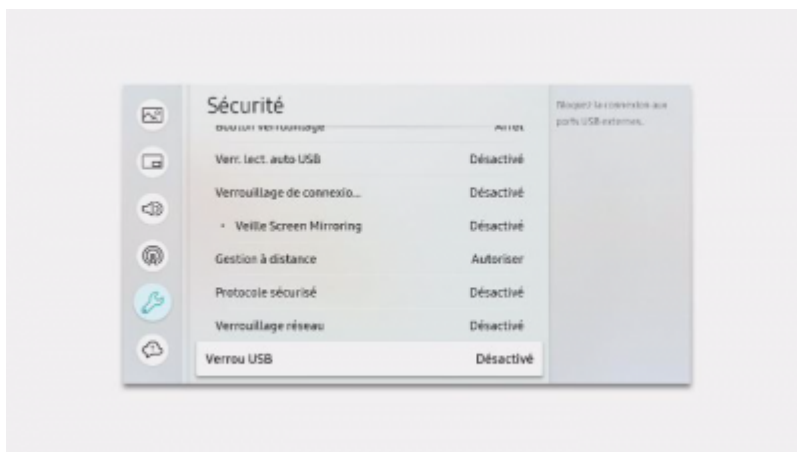

This option allows you to enable or disable power to the screen's USB ports. Note that to use a USB keyboard you will need to disable the lock.

From:

<https://documentation.zebrix.net/> - **zebrix documentation**

Permanent link:

https://documentation.zebrix.net/doku.php?id=en:restreindre_l_acces_externe_a_un_ecran_tizen

Last update: **2024/02/13 12:06**

