

Restricting external access to a Tizen screen

It is possible to control several security parameters on the Tizen screens: disabling USB ports, setting a PIN code, disabling the power button, etc... To access those parameters, go to Menu > System > Security, the default PIN code is 0 0 0 0.

This guide details each security function of the Tizen screens, some options will not be available depending on the model of your screen, do not hesitate to send us a notice if you discover a lack.

Please note that if you use a personalized PIN code, you will be the only person able to unlock the screen. If you forget it, the only possibility is a full reset of the screen.

Safety Lock On

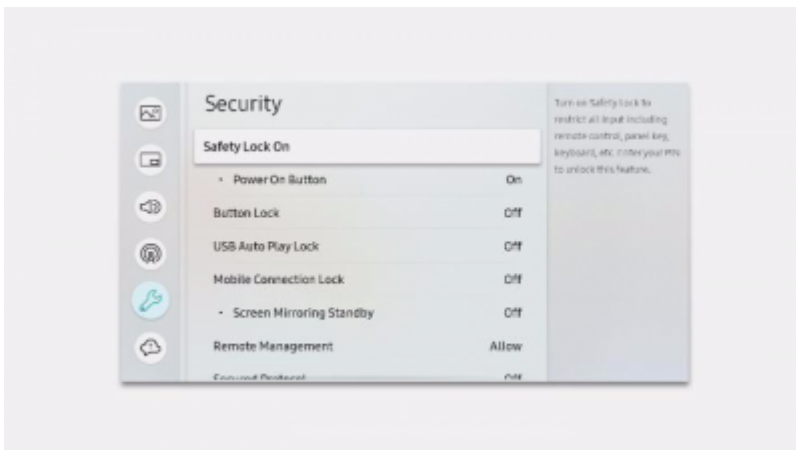

If you activate this option, all operations with the remote control will ask for a confirmation of the PIN code.

Power On Button

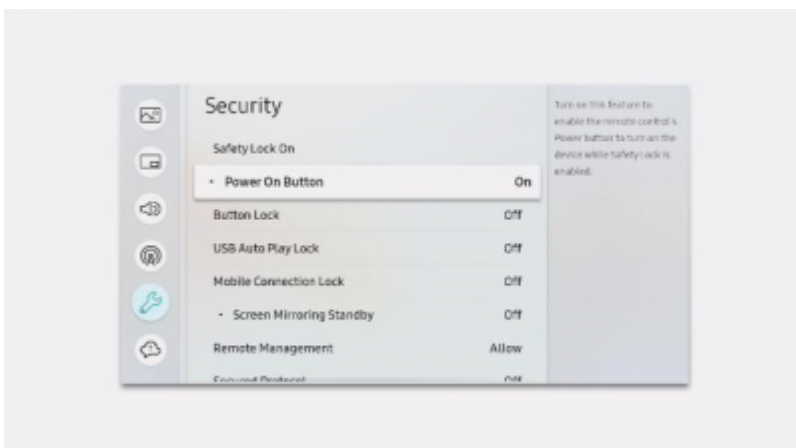

If this function is activated, you will no longer be able to turn on the screen via the remote control if the screen goes into standby mode.

Button Lock

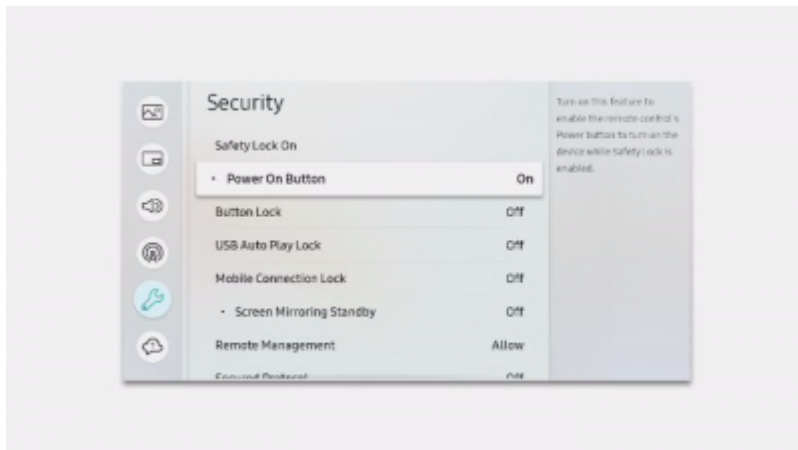

This option allows you to enable or disable the physical button on the screen

USB Auto Play Lock

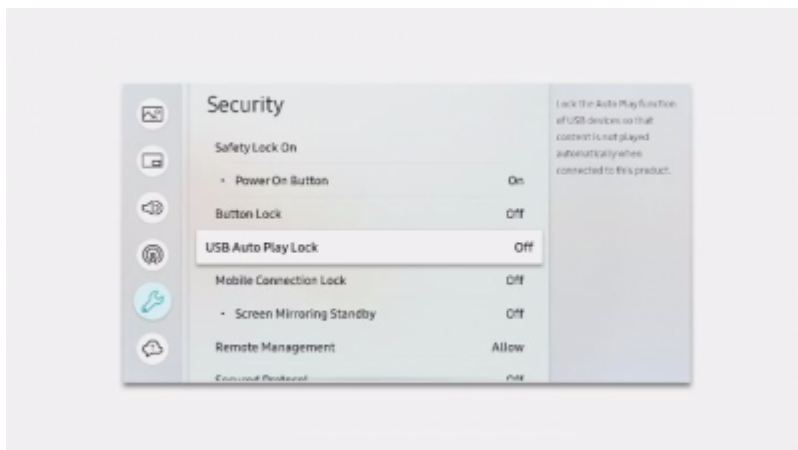

This option allows you to enable or disable auto playback when connecting a USB flash drive. (in MagicInfo)

Mobile connection lock

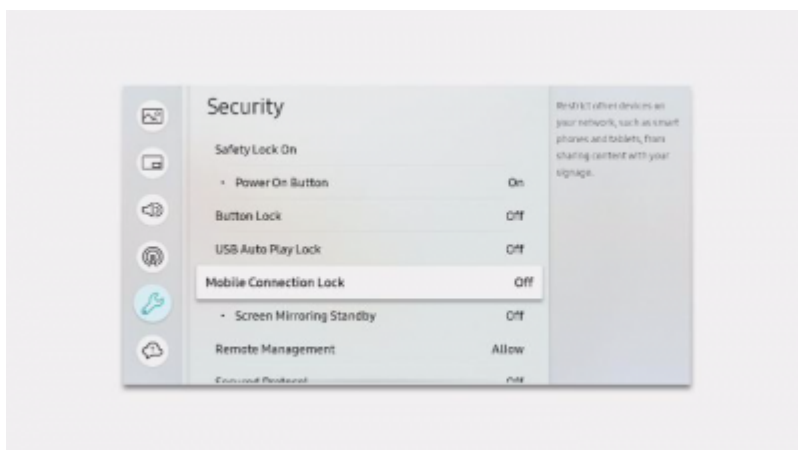

This option allows you to activate or not, the control of the broadcast by Screen Mirroring (smartphone, etc).

Touch control locks

This option allows you to disable the touch panel if your device is compatible.

Screen Mirroring standby

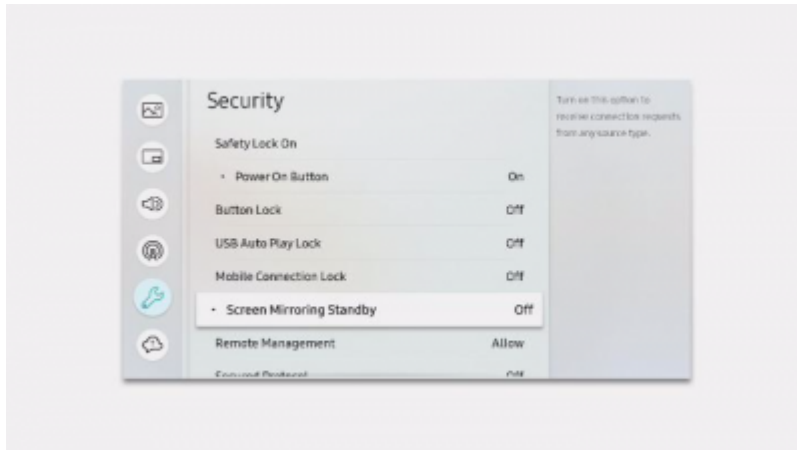

This option allows you to allow or disallow the resumption of old when the device is driven by Screen Mirroring (smartphone)

Remote management

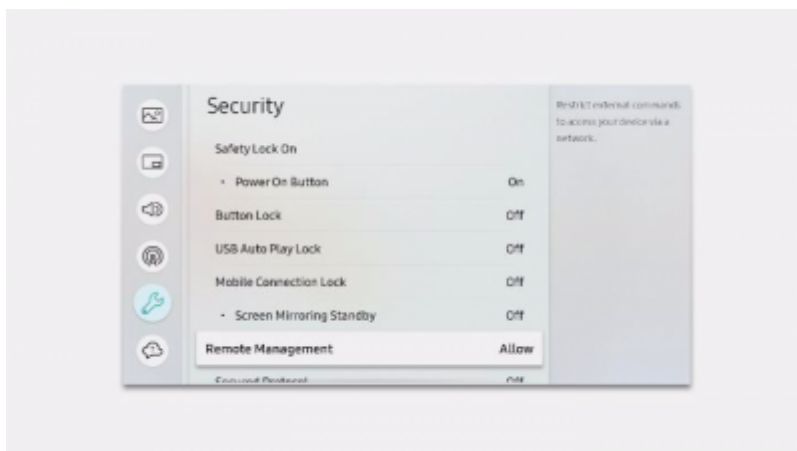

This option must be set to "Allow" to allow Zebrix to work properly.

Secured protocol

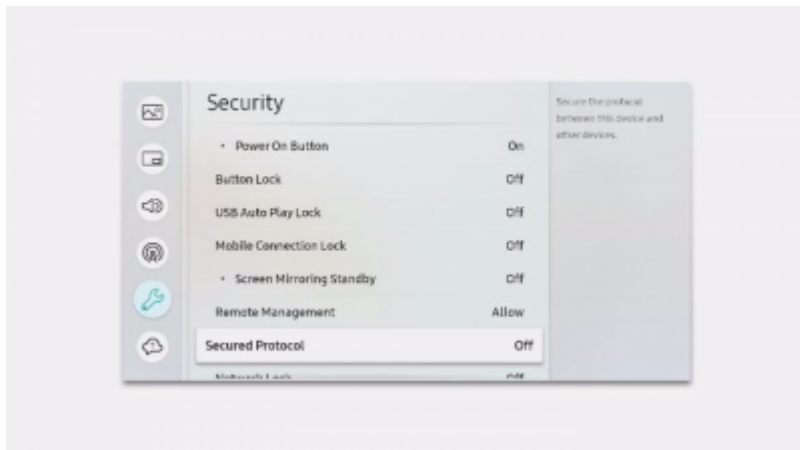

Secures the protocols between the screen and other peripherals.

Network lock

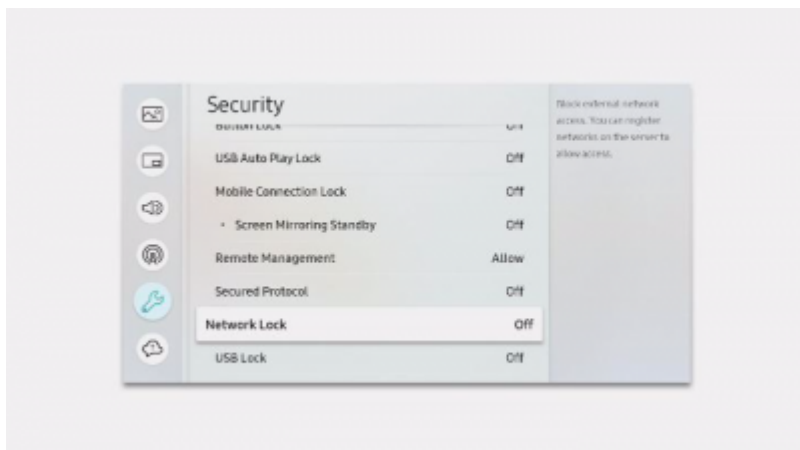

This option allows you to allow or disallow connection to networks other than the currently active one.

Usb lock

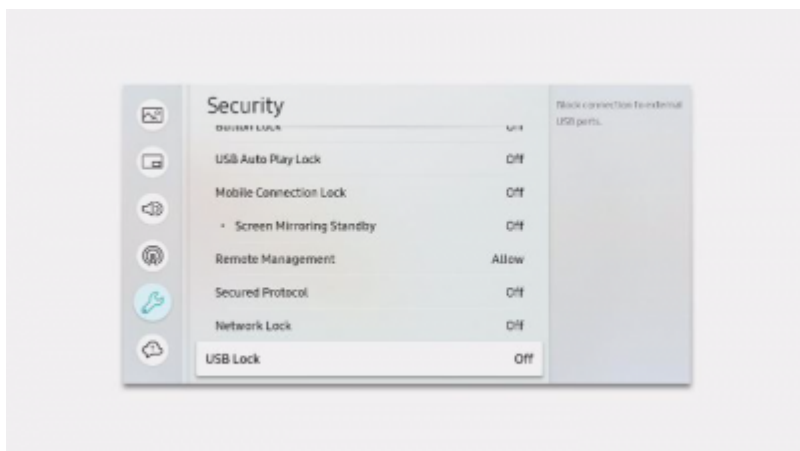

This option allows you to enable or disable power to the screen's USB ports, note that to use a USB keyboard you will need to disable the lock.

From:
<https://documentation.zebrix.net/> - **zebrix documentation**

Permanent link:
https://documentation.zebrix.net/doku.php?id=en:restricting_external_access_to_a_tizen_screen&rev=1596105943

Last update: **2020/07/30 12:45**

